

Idle Times

A publication designed to keep the Greater Idlewild Community informed about community matters
Spring 2018



Letter from the President

Greetings Idlewilders,

Spring has arrived in Idlewild. Unfortunately, what little snow there was over the winter is long gone. Because of this, moisture conditions in Idlewild and the surrounding areas are DRY. The National Weather Service's seasonal outlook for the next three months (March 15th to June 30th) is for persistent drought conditions. All of northern New Mexico is in an extreme drought condition. Because of this, Colfax County has issued a burn ban. The use of "exterior fireplaces, stoves, chimeneas, or charcoal briquette barbecues (except for gas-propane stoves and barbecues) and all open flames are prohibited. Chainsaws will be permitted provided the manufacturer's spark arrestor is in place. No burn permits will be issued at this time, and any current burn permits are hereby revoked." Additional information and updates are on the Colfax County website.

The dry conditions have decreased the natural food supply for wildlife. When you are in Idlewild, be aware that your furry neighbors are out looking for food. Please do not leave food or trash outside or in vehicles. Bears will break into vehicles to retrieve a snack. Please dispose of trash properly in the dumpsters in Eagle Nest.

Speaking of trash, let's talk trash.

The Eagle Nest Village Council reviewed the solid waste disposal fees at the March council meeting. Goose was notified and invited to attend the meeting. An interesting factoid is that last year was

the first year that the fees covered the cost of trash disposal. The Eagle Nest solid waste program has been in the red for many years. Goose advised the council that Idlewild residents have the following concerns regarding trash disposal:

- Idlewild residents are paying a higher fee than Eagle Nest residents;
- Idlewild resident are, with a few exceptions, seasonal residents;
- The tickets for disposal of six square yards at the Village dump were removed from the program; and
- The scheduled "free" days at the Village dump do not include any times when residents are in Idlewild.

There was discussion regarding these concerns. It was noted that the six free yards were taken away from Eagle Nest residents as well as those in Idlewild. Mayor Richard Cordova also stated that the fee is not based on the volume of solid waste but is a yearly fee for solid waste disposal. The mayor noted that the fee is part of the cost of owning property. A motion was made and passed to bring the Idlewild solid waste fee down to the same rate as that of the village residents. Future increases of the solid waste fee are tied to the

Consumer Price Index. There was discussion about scheduling a "free" date at the Village dump in June or July. No date has been scheduled at this time.

As part of our effort to go electronic and save our limited funds for important things like road repair and maintenance (please see Skip Johnson's "Update on Roads" in this newsletter), we have set up a Paypal account for payment of the annual assessment. If you have not sent in your assessment fee, please navigate to the website www.idlewildcommunity.org and click on the appropriate link to make your payment via Paypal. There is also a form to update information for the Idlewild Directory. We appreciate your support.

I'm looking forward to a fun-filled summer in Idlewild. Kim and Goose were instrumental last year in bringing back Game Night on Thursdays at the Community Center. Game Night will be back this year. Please join us in fun and frivolity and, on a clear night, in stargazing with Goose's telescope.

See you on the Mountain!

Maxi Millican, IWCC President

Inside this issue:

President's letter	1	New IWCC Guidelines/Evac Map	4-5
The Goose Report	2	Summer Events	6
Guest Ministers/Worship News	3	Early Assessment Payers	7
In Memoriam	3	Board Nominee Biographies	8
Firewise/Mass Email Campaign	4	Proxy Page	9
		Update on Roads	11

The Goose Report

Board of Directors

President: Maxi Millican
Vice President: Walter Davis
Secretary: Casey Bratton
Treasurer: Gabe Thornhill

Board Members

Casey Bratton
Walter Davis
Sandra Waters Gorohoff
Teresa Middleton Griffin
Chris Herring
Bill Hull
Maxi Millican
Becky O'Steen
Percy Reid
Phil Stickney
Gabe Thornhill
Bobby Weidenmaier

Committee Chairs

Archivist: Casey Bratton
Chapel: Sue Dorr
Community Center: Sue Dorr
Data Management : Frank Ray
Directory: Frank Ray
Facilities: Jerry Thomason
Don Woolsey
Firewise Rep: Frank Ray
Historian: Julia Putnam
Virginia Dorman
Maps: Frank Ray
Music Ministry: Ron Wells
Newsletter: Helen Hyams
Jerri Lynne Porter
Nominations: Sue Dorr
Potluck: Casey Bratton
Barbara Gibbs
Preacher Cabin: Donna Porter
Property: Bill Colson
Roads: Skip Johnson
Webmaster: Craig Sutton
Worship: Donna Porter

Safety First

After the first year of being your caretaker, I want to thank the Idlewild community for all your support. It has been a tremendous year with a huge learning curve and opportunity to get to know you. In this issue of the Goose Report, I would like to focus on the safety of our community.

Fire Safety

Since the weather this year has been different from last year's, I have had the opportunity to get a lot more roadwork and cabin work completed. Even though the lack of snow has allowed me to do more work, it has created a very dangerous fire situation. As it appears now, we will be in extreme fire conditions throughout the summer. Since safety is a priority, our community is going to undergo a review with the fire marshal; within the community we are developing egress maps for each road. At times, we will have to restrict travel on certain roads to ensure fire and emergency access, particularly when we have group gatherings.

Extreme Fire Conditions

Because of extreme fire conditions, we all need to be diligent in our behaviors. There will be *no* outside burning of any kind; that includes open barbecue grills, firepits, smoking outside a vehicle or structure, and driving off roads. There can be no outside welding or use of chain saws or lawnmowers. Fireplace ashes have to be put into metal containers that have a metal air-tight lid. They cannot be dumped or buried in the ground. With fire danger so high, do not drive off dirt roads. A fire can be caused in tall grasses from the catalytic converter in your vehicle. There have

already been several fires in Eagle Nest due to careless behaviors.

Cabin Safety

Another safety issue that needs to be addressed from the homeowner's perspective is cabin safety. It is important to have carbon monoxide and smoke detectors in each cabin and have the cabin evaluated for fire safety for such things as overhanging branches, excessive pine needles around foundations, and firewood stored in inappropriate locations around the house. If you ignore these procedures, you run the risk that the fire crew will



**SAFETY
FIRST**
in everything we do

not make an effort to save your cabin in an emergency. If you have any questions, please call me so that I can work with you to develop safety plan for your cabin. ***Community Safety***

We have had a couple of issues with cabin owners hiring contractors and those contractors hiring subcontractors who have not been vetted. There were several issues when untrustworthy people were in our community and thefts occurred. For the safety of all Idlewild cabins, please notify me about work being done so that I can be aware of who is in Idlewild. I have a list of contractors, plumbers, and electricians who have been vetted and who I can recommend if you need work performed on your cabin.

Road Safety

As always, one of the major concerns of all the residents is speeds on the roads and on the roads being maintained. The lack of snow this winter has allowed a lot of progress to be made on many roads, especially on Roads 9 and 15. We also have been working with the state to clean and evaluate all culverts on state and Idlewild roads and to develop a road plan to repair some of the worst roads that have high traffic and safety issues. Also, watch your speeds while driving. When people drive on our roads at high speeds, they destroy the roads, causing washboard conditions and road erosion around corners and in other places. If you would like to know more about future road plans, please contact me. Your input is highly valued.

Animal Safety

Because of our mild winter and the lack of nuts and berries, bears and large cats are on the prowl. We need to use extreme caution with food, trash, and bird feeders so as not to draw wild animals into the heart of our community.

Again, thank you for your tremendous support during my first year as caretaker. Kim and I appreciate your kindness. We welcome you to visit the caretaker's cabin next time you're in Idlewild. Come enjoy a cup of coffee or a refreshing beverage with us.

Kevin (Goose) Jarigese

Cell: 505-506-8467; Landline: 575-377-2228, Email: goose@idlewildcommunity.org

Guest Ministers, Summer 2018

June 17	Rev. Amy Lignitz Harken	Christian	Mattapoisett, MA
June 24	Rev. Amy Lignitz Harken	Christian	Mattapoisett, MA
July 1	Rev. Kim Ryan	Christian	Columbia, MO
July 8	Rev. Adam DeVries	Presbyterian	Nashville, TN
July 15	Fr. Jarod Houze	Episcopal	Sweetwater, TX
July 22	Rev. Dr. Bob Hill	Christian	Kansas City, MO
July 29	Rev. Arnold Nelson	Christian	Duncan, OK
Aug. 5	Rev. Johnny White	Interdenomination	Horseshoe Bay, TX
Aug. 12	Rev. Ken Cole	Methodist	Amarillo, TX
Aug. 19	Rev. Ron Holmes	Presbyterian	Woodway, TX
Aug. 26	Rev. Jack Kennedy	Interdenomination	Greeley, CO
Sept. 2	Fr. Randall Trego	Episcopal	Houston, TX

Worship Center News

Donna Porter, Worship Committee Chair

Our summer worship for 2018 will begin on June 17th, which is Fathers' Day. If you are in the area of Idlewild, please plan to join in. The Ministers' Cabin will be clean and fresh in preparation for the guest ministers who will lead our worship. Opening our year will be one of our favorites, who will drive to us from Massachusetts!! Reverend Amy Lignitz Harken will serve as our



minister for June 17th and 24th. She and her husband, Bruce, were married in our Chapel of the Pines and look forward to returning to us again. They are the couple that had our guest cabin bedroom ceiling spring down on them with all the rat debris.

Don Woolsey reports that we hope to install new siding on part of the cabin as prevention for any bat entry. If you are asked to contribute financially to this effort, we hope that you will support this needed project. Lots of ministers and

their friends and families have enjoyed our comfortable cabin. Let's all participate in taking care of it.

Be sure to share the news with your visiting family and friends that our outdoor services will take place every Sunday at 10:30 a.m. We look forward to the joyful singing of our choir, led by Ron Wells. Our guest ministers are exceptional, so you won't want to miss a single Sunday!!

See you in CHURCH!

In Memoriam

Carolyn Cunningham

Paul Hamilton

Don Herman

Norman McGill

Marcia Warner

Jack Watson

We remember those who have left us.

If you know of others we have not included here, please email frankray@swbell.net so they can be included in the bell ringing in July 2018.

Progress of Our Mass Email Campaign

Frank Ray, IWCC Firewise Representative

There are currently 234 Idlewild individuals subscribed in our MailChimp email list. A handful signed up via the link on www.IdlewildCommunity.org, and the rest have granted permission for an administrator to set up their subscription record. Several **was acquired**, and there is a written indication of that action by the person subscribed. There are still quite a few individuals who are distributing important information to our need to send to everyone is the “Firewise for 2018. Enough recipients are subscribed



checks were run **to make sure permission** will not or cannot participate in this form of population. One of the first documents we “Essentials” paper that will soon be updated to get the information in play.

If you wish to subscribe, navigate to the click on the button labeled “Join our in. The fields marked with an asterisk **must be filled in**, to help keep nonmembers from setting up bogus subscriptions. The goal is to have 100 percent participation by the year 2020.

community website URL underlined above, “Mailing List,” fill out the form, and you’re

Firewise Essentials

Frank Ray, IWCC Firewise Representative

I will be updating the **2018 Idlewild Firewise Essentials** paper in the next few weeks. It will again be stored in the **Files** section of our private Facebook Group, **Idlewild, NM**. If you are not familiar with this group, navigate to our website, idlewildcommunity.org, and click on the “FB” symbol on the home page to get to the FB Group. There are **new standards for reporting Firewise activity**, and these will be explained in the 2018 version of the paper. On the group’s home page, there is a column of buttons at the upper left. “Files” is at the bottom. All of the Idlewild files there are in PDF format.

Important Information from the Board!

We have two important additions to this issue of the *Idle Times*, which are shown on the facing page. These two forms will be reproduced on the front and back of a sheet of heavy card stock to be displayed in your cabin:

- 1. New Community Guidelines:** The Board of Directors has prepared a new set of Idlewild Community Guidelines. *This replaces any previous versions you may have.*
- 2. IWCC Evacuation Map:** The map has been designed by Goose, Fire Chief Scott Gibson, and Frank Ray, with generous cooperation and support from our neighbors, the Mutz and Gallagher ranches and the Taos Pueblo. It shows the most feasible routes that can be used to escape the community if a wild fire should break out. Any of the routes highlighted on the map will take you to a safer area. Gathering areas are noted in several places. Be aware that it may be impossible to go directly down Highway 127 toward town; emergency vehicles may commandeer the highway if necessary to fight a fire. Read “The Goose Report” in this newsletter for further information on plans for fire safety.

Goose and Kim have kindly offered to deliver the cards to all cabins in the community. We expect the new cards to be printed by June and distributed by the summer. If you do not receive yours in a reasonable time, please contact Goose or Kim.

IDLEWILD COMMUNITY GUIDELINES

1. Please respect your Idlewild neighbors. Cabin owners are responsible for their pets and for actions of their guests. New guests will need to be informed.
2. Outside fires and trash burning are never permitted.
3. ATV/OHV use will be confined to established community roads. Keep off private property and driveways, especially on Pueblo and private ranch lands that surround Idlewild. Also, vehicles must be registered in New Mexico.
4. Fireplace ashes should be stored in a metal container until COLD and then discarded in dumpsters or the village dump.
5. Keep roofs, gutters, chimneys and stovepipes free of all flammable materials and remove branches from above chimneys and stovepipes. All flammable materials on the ground must be more than 3 feet from cabin walls and not allowed to accumulate near flammable siding.
6. No mobile home, trailer, tent, or other temporary living quarters are permitted except for use during construction of permanent housing.
7. All garbage, trash, etc., must be put in dumpsters in Eagle Nest. The village prefers that we use the dumpsters across the street from the Village Offices where there are also assorted recycling bins. Non-household trash is to be taken to the village dump on the road to Red River.
8. Use of firearms, compressed air firearms, and fireworks is not permitted.
9. Outside noise ---vehicular or power tools, etc.--- is not permitted during the worship hour (10:30 –11:30 a.m.) on Sundays from Father's Day through the Labor Day weekend.
10. Do not feed any wildlife. A fed bear is a dead bear. New Mexico Game and Fish can fine you up to \$500.00 if a bear eats whatever food you might have put outside.
11. When calling 911, give the cabin owner's name, road number and cabin number. If available also give the ERA Zone (1–8) number found on the Idlewild map and in the Idlewild Directory.
12. Cabin Owners: Please post your name and Idlewild address close to the phone for possible guest 911 calls. For example, 24 Rd 6 is House 24, Road 6.
13. Make sure your official reflective Firewise address sign (house number only) has been properly installed near your driveway. The caretaker can assist with this project.

See other side for evacuation information

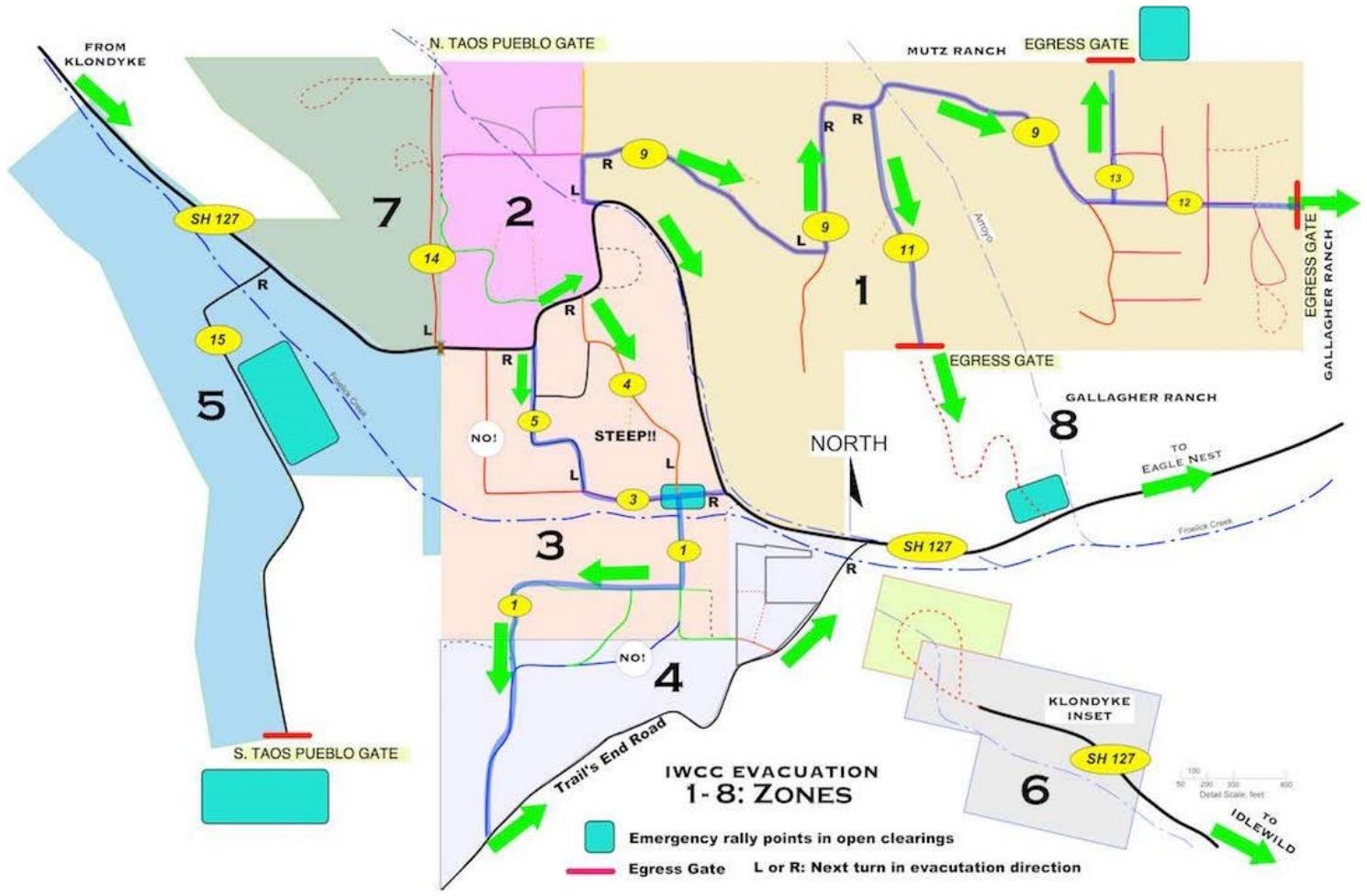

Summer Events

Idlewild Events for Summer 2018

June 17 to Sept. 2	Church services at the chapel, 10:30 a.m. Sundays
Thursday nights	Game Nights in the Community Center, run by Goose and Kim
July 3	Hot Dog Cookout, 5:00 p.m., Idlewild Community Center
July 20	Poetry Party, 5:30 at the Colson Cabin, 29 Rd. 4, call 214-212-5164
July 28	Board of Directors Meeting 10:00 a.m., Community Center
July 29	Potluck Lunch 11:30ish, Community Center
July 29	Annual Meeting 12:30 p.m., Community Center
July 29	Board of Directors Meeting, Community Center, after Annual Meeting
Sept. 2	Potluck Lunch, 11:30ish, Community Center

3rd of July Party

The annual Hot Dog Cookout will be held again this year on Tuesday, July 3rd, at 5:00 p.m. (or after the rain stops).

The IWCC is again hosting the event at the Community Center. Volunteers are needed to help. Please email or call Maxi Millican if you can help, at maxitoo@swbell.net or 817-988-1409.

Bring your own tables, chairs, and a covered dish to share. Hot dogs, chili, tea, lemonade, and water will be provided. Bring games for the kids to play and enjoy meeting your neighbors.

We look forward to seeing you there!



July 4th

Fireworks Over Eagle Nest Lake

Get to your favorite viewing spot by dark-thirty and ENJOY!!!

Eagle Nest Parade

The July 4th parade will begin at 2:00 p.m. Wednesday in Eagle Nest. Arriving early with your lawn chair is highly recommended for a good view.

Be sure to eat lunch or dinner (or both) at the Firemen's annual BBQ fundraiser from 11:00 a.m. to 5:00 p.m. This annual event raises money for the Eagle Nest Volunteer Fire Department. As always, their motto is "You come to our BBQ, we'll come to your fire."

In partnership with "Friends of Eagle Nest Lake," Idlewild will be putting together a float for the 4th of July parade, similar to last year's "boat float." We encourage Idlewild participants to help build the float *and to ride in the parade*. This year's theme will feature year-round activities and include a mountain bike and skis. All those with bikes can ride alongside the float and throw candy to the crowd. Contact Kim and Goose for further information and to participate in the parade!

In addition, during the week of the 4th of July, the Village of Eagle Nest and Friends of Eagle Nest Lake will celebrate the centennial of Eagle Nest Dam. The celebration will kick off at 12:00 noon on June 30th with events planned throughout the week. A list of these events is on the Idlewild Facebook page and website.



Early Assessment Payers 2018

Thanks to all who sent an early donation. A free copy of the 2018 IWCC Directory will be mailed to your home.

Name	IW Prop.	Name	IW Prop.	Name	IW Prop.	Name	IW Prop.
Anthony	16 Rd 6	Gee	60 Trail's End	Lewis, M.	87 Rd 9	Stickney	271 Hwy 127
Anthony, O.	62 Trail's End	George	29 Rd 13	Lewisville	36 Rd 11	Stone, D.	19&35 Rd 3
Axe	15 Rd 14	Gibbs, B.	360 Hwy 127	Macina	252 Hwy 127	Stone, D.	19&35 Rd 3
Bailey	128 Rd 9	Gibson	237 Hwy 127	Martin, J.	91 Trail's End	Stone, Dg.	15 Rd 3
Barnard	11 Rd 14	Gilcrease	Vacant (B51)	McClure	28 Rd 5	Stone, Jr., D.	29 Rd 3
Blankenship	102 Rd 9	Goodwin, C.	10 Rd 10	McKinney	12&16 Rd 15	Sutton	276 Hwy 127
Blanton	46 Rd 12	Goodwin, R.	364 Hwy 127	McMahan	26 Rd 3	Taylor	12 Rd 6
Bonner	254 Hwy 127	Goodwin/Herrera	278 Hwy 127	McNair	105 Rd 9	Theford	Vacant (B44)
Boulware, D.	25 Rd 4	Graham	75 Enchanted	Medford	27 Rd 9	Thomas	71 Rd 12
Boulware, M.	39 Rd 4	Griffith/Wilkinson	36 Rd 3	Miller/Via	13 Rd 9	Thomason	17 Rd 14
Bowen	14 Rd 6	Hare	32 Rd 1	Millican	20 Rd 15	Thompson	Vacant (B124)
Bratton	22 Rd 5	Hargrave	65 Rd 9	Mixon	257 Hwy 127	Thornhill	77 Rd 9
Brisbin	56 Trail's End	Hart	20&22 Rd 8	Montague, F.	352 Hwy 127	Thornhill, G.	Vacant (B5)
Brooks	36 Rd 1	Hatfield	33 Rd 3	Moran	299 Hwy 127	Valdez	Vacant (B52)
Brown, R.	37 Rd 1	Hausler	Vacant (B1,33,66,125)	Mueller	16 Rd 5	Vecchio	51 Rd 1
Brucker	82 Enchanted	Henthorn	92 Rd 9	Naylor	232 Hwy 127	Vucich	57 Rd 12
Brucker	240 Hwy 127	Herman	61 Rd 9	Nunley	Vacant (B94)	Waneen Co.	43 Rd 3
Bryant	Vacant (B1)	Herring	28 Rd 6	O'Quin	39 Rd 2	Waters	116 Rd 9
Butler	33 Rd 11	Hilburn	26 Rd 7	O'Steen/Mizar	40 Rd 4	Watson	25 Rd 5
Butler/Richardson	29 Covington	Hornsby	19 Rd 4	Owens	Vacant (B2)	Weidenmaier	269 Hwy 127
Castleberry	40 Rd 12	Houser	27 Rd 4	Palmer	90 Rd 9	Wells/Sudduth	30 Rd 6
Cernosek	28 Rd 7	Howard	11 Rd 9	Patterson	14 Rd 13	Wheeler	32 Rd 5
Coleman	371 Hwy 127	Hukill	40 Rudis Rd	Paulsell	25 Rd 9	Whitten	Vacant (B63)
Colson	29 Rd 4	Hull, C.	25 Rd 15	Porter	317 Hwy 127	Willburn, E.	40 Rd 1
Couch	106 Rd 9	Hull, J.	10 Rd 15	Posey	14 Rd 10	Willburn, F.	85 Enchanted
Covington	21 Covington	Hull, K.	38 Rd 15	Raef, J.	53 Rudis Rd	Willburn, J.	79,81,83 Enchanted
Craig	301 Hwy 127	Hull, W.	47 Rd 3	Randall	52 Rd 9	Willburn, R.	50 Trail's End
Cullender	33 Rd 9	Hullum	268 Hwy 127	Ray	24 Rd 6	Williams, C.	20 Rd 13
Cunningham	125 Rd 9	Irby	11 Covington	Reeder	260 Hwy 127	Williams, E.	11 Rd 12
Davis, W.	258 Hwy 127	Jackson-Paton	10 Trail's End	Reedy, J.	65 Rd 12	Williams, L.	15 Rd 10
Davis, W.	263 Hwy 127	Jefferson	67 Rd 9	Reid	48 Enchanted	Woolsey	221 Hwy 127
Doolin	40 Rd 9	Johansen	91 Rd 9	Reynolds	109 Rd 9	York	77 Enchanted
Dorman	20 Rd 6	Johnson Compnd.	279 Hwy 127	Runner	190 Hwy 127		
Dorr	42 Rd 6	Johnson, L.	44 Rd 9	Rupprecht	46 Rd 9		
Duby	49 Rd 2	Johnson, R.	267 Hwy 127	Russell	15 Rd 4		
Duncan, J.	Vacant (B45)	Kaye	25 Rd 6	Schmidt, M.	348 Hwy 127		
Duncan, R.	21 Rd 3	Kirk/Brashear	46 Rd 3	Schudy	21 Rd 14		
Dunlap	70 Rd 12	Knupp	45 Rd 3	Shaller	30 Rd 5		
Forbis/Prather	114 Rd 9	Kopenits	15 Rd 11	Sluder	42 Rd 12		
Fore	86 Rudis Rd	Lambert	34 Rd 4	Speed	Vacant (B66,79)		
G. Bailey	Vacant (B20, 53)	Laminack	54 Trail's End	Stahl	23 Rd 14		
Gaston	272 Hwy 127	Langen	Vacant (B140)	Stevens	244 Hwy 127		



Board Nominee Biographies



Bill Hull

I've been coming to Idlewild since the mid-1940s. Our old family cabin is still here; my brother, sister, and nephew also own properties in

Idlewild. I am married to Barb, and have three children, eight grandchildren, and two great-grandchildren. I enjoy fly fishing, reading, and working on old clocks.

Benny Rupprecht

My name is Benny Rupprecht and my wife is Connie. I was raised in Perryton, Texas, and graduated high school there. I attended Northwestern Oklahoma State University on a track scholarship, where I met my wife, Connie. After graduating with a teaching degree in math and physical education, I started teaching and coaching in Canadian, Texas, in 1973. We moved to Graham, Grapevine, and Burleson, Texas, coaching and teaching, and came full circle back to Canadian to operate an oil and gas business ten years later.



After 35 years in the oil field, I just retired in July 2017, and we are enjoying spending more time in the beautiful mountains. We have a grown daughter, Amber; her husband is Shane Harper of Amarillo, Texas. We have two wonderful grandkids: Hagen, age 14, and Keely, age 12. We also have a son,

Bryan, who now lives in Heaven—the cabin was his favorite place on earth.

We bought our cabin in 1976 with my sister and brother-in-law, Mike and Sharon Hargrove. In 2000, my wife insisted on an indoor bathroom, resulting in a huge remodeling project that Mike and Sharon could not justify, as their home is in Ohio, so we took over the cost and ownership of the cabin "Close to Heaven."

I look forward to serving on the Idlewild Board of Directors. I also look forward to getting to know more of our mountain friends. Stop by the cabin and have a cup of coffee with me anytime.

Donna Woolsey

My name is Donna Woolsey, and I am married to Don Woolsey. Together we have four children and nine grandchildren, who all love to visit Idlewild and enjoy our great community.

Don has always wanted to live in Idlewild full-time, so this winter we sold our home in Amarillo and currently call our cabin home sweet home.

Our property is located in front of the Idlewild caretaker's property. It's the tall building with the three bears on the side.

I retired in 2009 from a career with Ford Motor Company. I worked with Ford 31 years, managing their finance arm throughout the United States. Since retirement, I have volunteered and organized charity events for "Sharing Hope Ministry" out of Amarillo TX.



Since moving to Idlewild, I have joined the board of "Friends of Eagle Nest Lake," and am active in functions to promote and support Eagle Nest Lake events.

Gabe Thornhill

I've been coming to Idlewild since I was a child. My grandparents built a cabin in the 1950s and my mother, Mary Lib Thornhill, added on and improved the cabin over the years. An old outhouse still stands behind the cabin as a reminder of how much things have changed in the last 60 years. My wife, Susie, and our three boys, Curry (25), Gabriel (17), and Travis (15), all enjoy our time in New Mexico

I've been the treasurer for Idlewild Community Center since 2014 and

have enjoyed working with the board and getting to know more of our neighbors over that time. As treasurer, I pay the bills, collect assessments during the assessment process, report fi-



nancials, and prepare a budget for the board. It's been an honor to serve the community over the last few years and I look forward to the coming year.

Proxy

The Nominating Committee for the 2018 elections (Sue Dorr, Don Woolsey, and Ann Knupp Matta) has nominated the following individuals for a three-year term ending in 2021 on the Board of Directors. Information about each individual is in this newsletter.

Name of Nominee	FOR	AGAINST
3-YEAR TERM		
Bill Hull		
Benny Rupprecht		
Gabe Thornhill		
Donna Woolsey		

After making your selections, this proxy letter should be sent to:

The Idlewild Community
P.O. Box 225
Eagle Nest, NM 87718

Use this document to mail. You may cut out this page and fold it in thirds so that the address on the back is in the proper place. Tape the page shut and adhere postage.

Submissions must be received by Friday, July 27, 2018, in order to be counted.

Proxy – For the member of Idlewild Community Center, a New Mexico Corporation, this proxy is solicited on behalf of the Board of Directors.

The undersigned appoints the Board of Directors, as the proxy of the undersigned, with power of substitution, to vote and otherwise represent the undersigned at the annual meeting of members of the Corporation at 12:30 p.m. on July 29, 2018, at the Community Center, Idlewild, Colfax County, New Mexico, and any adjournments thereof, with the same effect as if the undersigned were present and voting, on the following matters and in the following manner.

- (1) The election of the above persons as directors of the Corporation to serve until the next annual meeting of members and until their successors are elected and qualified.
- (2) To vote or otherwise represent my membership on any other business or on other matters which should properly come before the meeting or any adjournments thereof according to its decision.

In the event this proxy is not returned to the Chairman, the membership represented by this proxy will be voted **FOR** each of the above persons and/or proposals.

Print Name

Signature

Date

The Idlewild Community

P.O. Box 225

Eagle Nest, NM 87718

Update on Roads

Skip Johnson, Road Committee Chair

One of the primary, some would say the most important, IWCC board functions is maintenance of our roads. Rain and snow can be both a blessing and a curse. Insufficient moisture leads to drought and all the unpleasant things that come with it; however, too much moisture is harmful to dirt roads. Abundant rain and snow are, for the most part, not a problem *except for dirt roads*.

Our road system truly suffered this past year. After an abundant snowfall during the 2016–2017 winter, the precipitation simply *did not* quit: *rain, rain, rain, more rain, much more rain!* The extremely intense summer-2017 rains were quite unusual and the result of thunderstorms losing their forward motion, becoming stationary, and raining out without further movement. At one point in early August it rained so intensely that the main road (Hwy. 127) washed out at a couple of lengthy places between the caretaker's cabin and the Mixon cabin. Thankfully, our caretaker, Kevin Jarigese, was on duty and got the situation stabilized until the county could re-grade that section the following day. Now, it is generally not a good thing to complain about rain, but this past year there was much more precipitation than our roads could handle.

The board takes road conditions and maintenance as a serious matter. Cabin owners should be able to travel to their cabins over reasonably maintained country dirt roads. Road maintenance is a significant portion of the IWCC annual budget. With the frequent and intense rains, hiring a contractor to apply materials to our roads this past summer would have been like burning dollar bills.



In a normal year, the Road Committee generally reviews roads each year after the April mud season and performs necessary maintenance (grading, spreading gravel, filling holes, etc.) so that the roads are generally in good shape for the start of the summer season around Memorial Day or the first part of June. Depending on summer rainfall, additional maintenance may be required, to be performed as is necessary and as our funding allows. Our funding comes from IWCC cabin and property assessments, which also must cover our other community needs (caretaker, community property, insurance, etc.). This past winter has been extremely dry with no significant snowfall. Recognizing that this last year was not typical of the past several and knowing our budgetary constraints, the board has initiated several steps to help the road situation. Following the winter, we plan to initiate our normal road

maintenance plan so that roads are in good shape by the Memorial Day holiday.

Kevin has made good use of the unusually dry conditions to make several road improvements. He has had material deposited at several locations around Idlewild and has used his equipment and had a contractor assist in making significant improvements to several locations. Of particular note are Roads 15 and 9. We were in danger of washing out the Froelich Creek culvert on Road 15 near Highway 127. The road there has been completely reworked, the culvert reset, and the roadway elevated to prevent water overflowing Road 15. This should eliminate the virtually constant wet areas on Road 15 near the creek.

As of this writing, a significant amount of work has been performed with more planned on Road 9 from the intersection with Roads 8 and 10 to the culvert across Road 9 near the intersection with Road 11. Several places along this stretch have been improved with the additional work to be done shortly if the dry weather holds. Kevin deserves kudos for developing and fostering a good relationship with Nate Kite and for working with Nate to get a significantly reduced equipment rate for working on some of the stretches of both Roads 15 and 9 where heavy equipment was, and will be, needed to make the necessary improvements. Nate Kite also deserves our thanks for his company's assistance to Idlewild.

How can YOU help?

All of us can help to minimize maintenance on both our roads and our individual driveways. Two keys are to watch your speed and where you drive. Well, the first is obvious. Excessive speed is damaging to roads and your vehicle (not to mention to kids who may be playing in or near the road). The second should be obvious to all who have lived in an area with unpaved driveways. If you continuously drive along exactly the same track, your wheels will begin to create small ruts in an unpaved roadway or driveway. With a little rain and continued driving in the same tracks, potholes are formed and grow larger with time. So don't drive in exactly the same track all the time. Just move slightly to the left or right. It's just common sense and it will help the roads and your driveway.

Idlewild Community
c/o Kevin Jarigese
P.O. Box 225
Eagle Nest, NM 87718
